

SURVEY FOR DESIGNATED SUBSTANCES AND HAZARDOUS MATERIALS



**WEST SCARBOROUGH NEIGHBOURHOOD COMMUNITY CENTRE
313 PHARMACY AVENUE
TORONTO, ONTARIO**

Prepared for:
City of Toronto
Corporate Real Estate Management
Attention: Sara Reid

Prepared by:
ECOH
75 Courtneypark Drive West, Unit 1
Mississauga, ON L5W 0E3

ECOH Project No.: 25715-B077
November 27, 2020



EXECUTIVE SUMMARY

ECOH was retained by The City of Toronto to conduct a survey for designated substances and hazardous materials at the West Scarborough Neighbourhood Community Centre located at 313 Pharmacy Avenue in Toronto, Ontario (hereafter referred to as the “facility” or the “project area”).

The objective of the survey was to determine the condition of previously identified asbestos-containing materials (ACM), identify and assess the condition of designated substances and other hazardous materials, and, if necessary, provide recommendations to assist the City of Toronto in fulfilling requirements to achieve regulatory compliance, as set forth under the Ontario Occupational Health and Safety Act, and enforced by the Ontario Ministry of Labour. This document should be filed as an addendum to the original survey report, which was issued by Paradigm Environmental and Industrial Hygiene Consultants in January 1987.

This designated substances survey report is for management purposes only. It is not intended to be used to establish the presence of designated substances or hazardous materials in building materials prior to demolition or renovation activities. **A pre-renovation/pre-demolition audit of the work area for designated substances and hazardous materials should be conducted prior to any work activities that may disturb building materials potentially containing designated materials or hazardous substances.**

Brittanie Semper of ECOH performed the fieldwork on October 6, 2020.

FINDINGS

The following presents a brief outline of ECOH’s findings within the facility. Refer to Appendix II for analytical results for asbestos. Refer to the main body of the report and Appendices I and IV for specific details, quantities, conditions and locations of Designated Substances and Hazardous Materials within the facility.

Material	Findings
Asbestos	<p>Asbestos-containing materials (ACM) were identified in the facility as follows:</p> <ul style="list-style-type: none">• Texture coat on ceilings throughout the facility (1% Chrysotile asbestos). <p>Assumed ACM were identified in the facility as follows:</p> <ul style="list-style-type: none">• Vinyl floor tile mastic, leveling compound, drywall joint compound, plaster, window caulking and roofing materials throughout the facility. These materials were not sampled and should be assumed to be asbestos-containing, as per the project scope of work.
Lead	<p>No major sources of lead or lead-containing products were identified during the survey; however, lead may be present in:</p> <ul style="list-style-type: none">• Wiring connectors and electric cable sheathing, and• Piping and solder joints/bell-and-spigot joints on piping.
Mould	<p>Mould growth was not noted during the survey.</p>

EXECUTIVE SUMMARY

Material	Findings
Mercury	Minor quantities are present as a vapour within fluorescent tubes lights and as a possible constituent of paints and adhesives.
Silica	Present in all concrete and masonry products.
Polychlorinated Biphenyls (PCBs)	Assumed to be present as a component of ballasts for fluorescent lights. Approximately 500 light fixtures are present within the facility.
Benzene	No potential sources of Benzene were identified.
Other Designated Substances and Hazardous Materials	Acrylonitrile, Arsenic, Coke Oven Emissions, Ethylene Oxide, Isocyanates, and Vinyl Chloride Monomer were not noted in significant quantities or forms, if at all.

RECOMMENDATIONS

Asbestos

Ontario Ministry of Labour Regulation 278/05 requires that an Asbestos Management Program (AMP) be implemented as long as asbestos-containing materials are present in a building. The AMP, original survey report and subsequent reassessment reports must be made available at the work place, and must identify the type of asbestos and where asbestos can be found on a room-by-room basis.

Lead

The removal of all building materials assumed or confirmed to be lead-containing (i.e. having lead concentrations >0.1% (1000ppm)) should be conducted following recommendations detailed within the Ministry of Labour document "*Guideline - Lead on Construction Projects*", dated June 2011 and the Environmental Abatement Council of Ontario (EACO) document "*Guideline for Construction, Renovation, Maintenance or Repair*", dated October 2014.

Renovation, demolition or general construction work involving the removal of materials containing only trace concentrations of lead (i.e. Concentrations below 0.1% (1000ppm) by dry weight) can be completed without lead specific safety precautions provided that:

- work does not include 'fume generating activities' (heat producing) such as welding, torching, burning, high temperature cutting, etc.,
- work does not include dust-generating activities such as grinding, cutting or chemical stripping,
- dust levels are maintained below $3\text{mg}/\text{m}^3$, and
- general health and safety construction procedures are implemented, which would include dust suppression methods, proper respiratory protection (minimum of a 1/2-face respirator) and protective clothing, as is appropriate for the work being completed.

EXECUTIVE SUMMARY

Mould

The removal of all mould-affected building materials should be conducted following recommendations detailed within the Canadian Construction Association, Standard Construction Document CCA 82, 2004; “*Mould Guidelines for the Canadian Construction Industry*” or the Environmental Abatement Council of Ontario (EACO) *Mould Abatement Guidelines*, Ed. 3 (2015).

PCBs

PCB-containing light ballasts may legally remain in use until December 31, 2025, if they were already in use in the facility on September 5, 2008. However, it is ECOH’s general recommendation that PCB ballasts are proactively removed to eliminate the possibility of ballasts rupturing and requiring costly remediation.

Disposal of fluorescent light ballasts that contain PCBs must follow Ontario Regulation 347, General –Waste Management, Ontario Regulation 362, Waste Management – PCB’s, and the amended PCB Regulations, 2008 established under the Canadian Environmental Protection Act, 1999.

Complete commentary on each of the designated substances in the project area can be found in the body of this report. The executive summary is not intended to substitute for the complete report, nor does it discuss certain specific issues documented in the report.

TABLE OF CONTENTS

EXECUTIVE SUMMARY.....	i
1. INTRODUCTION AND REGULATORY REQUIREMENTS	1
1.1 Introduction and Scope	1
1.2 Regulatory Requirements	2
2. SURVEY METHODOLOGY	2
2.1 General Approach.....	2
2.2 Asbestos Survey Methodology.....	3
2.3 Lead Methodology	3
2.4 Mould Assessment.....	4
2.5 Assessment for PCBs	4
2.6 Hazardous Materials Survey Inventory.....	4
2.7 Survey of Other Hazardous Materials	4
3. FINDINGS AND RECOMMENDATIONS.....	4
3.1 Asbestos.....	4
3.2 Lead.....	5
3.3 Mould.....	5
3.4 Mercury.....	5
3.5 Silica	6
3.6 Polychlorinated Biphenyls (PCBs).....	6
3.7 Other Environmental Considerations.....	6
4. RECOMMENDATIONS	7
4.1 Asbestos.....	7
4.2 Lead.....	7
4.3 Mould.....	8
4.4 Mercury.....	8
4.5 Silica	8
4.6 Polychlorinated Biphenyls (PCBs).....	8
4.7 Other Substances	9
5. CORRECTIVE ACTIONS.....	9
6. STATEMENT OF LIMITATIONS	9

APPENDICES

Appendix I:	Hazardous Materials Inventory Sheet
Appendix II:	Results of Bulk Sample Analyses
Appendix III:	Visually Identifiable Asbestos-Containing Material Info Sheet
Appendix IV:	Survey Drawings

1. INTRODUCTION AND REGULATORY REQUIREMENTS

1.1 Introduction and Scope

ECOH was retained by The City of Toronto to conduct a survey for designated substances and hazardous materials at the West Scarborough Neighbourhood Community Centre located at 313 Pharmacy Avenue in Toronto, Ontario (hereafter referred to as the “facility” or the “project area”).

The objective of the survey was to determine the condition of previously identified asbestos-containing materials (ACM), identify and assess the condition of designated substances and other hazardous materials, and, if necessary, provide recommendations to assist the City of Toronto in fulfilling requirements to achieve regulatory compliance, as set forth under the Ontario Occupational Health and Safety Act, and enforced by the Ontario Ministry of Labour. This document should be filed as an addendum to the original survey report, which was issued by Paradigm Environmental and Industrial Hygiene Consultants in January 1987.

This designated substances survey report is for management purposes only. It is not intended to be used to establish the presence of designated substances or hazardous materials in building materials prior to demolition or renovation activities. **A pre-renovation/pre-demolition audit of the work area for designated substances and hazardous materials should be conducted prior to any work activities that may disturb building materials potentially containing designated materials or hazardous substances.**

Brittanie Semper of ECOH performed the fieldwork on October 6, 2020.

The survey included an investigation for the presence of designated substances, namely:

- Asbestos
- Lead
- Mercury
- Silica
- Acrylonitrile
- Arsenic
- Benzene
- Coke Oven Emissions
- Ethylene Oxide
- Isocyanates
- Vinyl Chloride Monomer

And, in addition, investigation for:

- Mould
- Polychlorinated Biphenyls (PCBs)

The following report details the project regulatory requirements, survey and analytical methodologies, findings and recommendations, and survey statement of limitations.

1.2 Regulatory Requirements

Regulatory requirements and guidelines applicable to the designated substances and hazardous materials noted above include, but are not limited to, the following:

- Ontario Occupational Health and Safety Act and applicable Regulations made under the Act including;
 - Designated Substances – Ontario Regulation 490/09, and
 - Designated Substance – Asbestos on Construction Projects and in Buildings and Repair Operations – Ontario Regulation 278/05.
- Ontario Environmental Protection Act, and applicable regulations made under the Act.
 - General – Waste Management – Ontario Regulation 347
 - Waste Management – PCB's – Ontario Regulation 362.
- *Canadian Environmental Protection Act, 1999* and applicable Regulations made under the Act, including:
 - PCB Regulations (SOR/2008-273), amended Dec 8, 2011.
- Ministry of Labour Guideline, "*Lead on Construction Projects*", dated April 2011,
- Ministry of Labour Guideline, "*Silica on Construction Projects*", dated April 2011.
- Canadian Construction Association, Standard Construction Document CCA 82, 2018; "*Mould Guidelines for the Canadian Construction Industry*",
- Environmental Abatement Council of Ontario (EACO) *Mould Abatement Guidelines*, Ed. 3, 2015.
- Environment Canada Document, "*PCB Identification of Lamp Ballasts Containing PCBs*", EPS 2/CC/2, dated August 1991.
- Environment Canada Document, "*Handbook on PCBs in Electrical Equipment*" EN 47-310/1988E, dated April 1988.

2. SURVEY METHODOLOGY

2.1 General Approach

To ensure familiarity with the building, and prior to commencing the survey, the surveyor made reference to previous surveys, facility floor plans, and other available documentation. The surveyor looked for the most common applications of building materials made with Designated Substances based on historical applications. The investigation performed was non-intrusive in nature (i.e. did not include demolition of building systems to verify concealed conditions).

2.2 Asbestos Survey Methodology

2.2.1 Asbestos Sampling Strategy and Analytical Methods

Where sampling was required, bulk samples of potentially asbestos-containing materials were collected for analysis. As per the requirements of Ontario Regulation 278/05: multiple samples (ranging from 3 to 7 depending on quantity and type of material) are required to confirm that asbestos is not present in that given material. Only one positive result (i.e. confirming the presence of asbestos) is required to classify a material as asbestos-containing. Therefore, ECOH's sampling strategy involves the collection of sufficient numbers of samples to meet regulatory requirements, followed by instructions to the laboratory to cease analysis of all remaining samples within a series when a sample within that series is determined to be asbestos-containing.

Sampling requires a small volume of material to either be removed from a damaged section of suspect material or cut from intact material, which is then repaired by sealing with tape to prevent fibre release. The collected samples are placed in plastic bags, sealed, and shipped to an independent laboratory. A formal chain of custody procedure is maintained between ECOH and the sub-contracted laboratory during sample transport. Samples are analysed following the analytical procedure prescribed by the Regulation 278/05 U.S. Environmental Protection Agency Test Method EPA/600/R-93/116: Method for the Determination of Asbestos in Bulk Building Materials. June 1993. Although not required by provincial regulation, all laboratories used by ECOH are accredited under the U.S. National Voluntary Laboratory Accreditation Program (NVLAP) to ensure consistent, accurate and defensible results.

Materials confirmed to be asbestos-containing during any previous assessments of the facility (if applicable) were not re-sampled for this survey. Additionally, samples were not collected of materials that were previously confirmed to be non-asbestos per the requirements of Ontario Regulation 278/05.

2.3 Lead Methodology

Where sampling was required (i.e. where damaged materials were observed), bulk samples of potentially lead-containing materials were collected for analysis by flame atomic absorption spectroscopy. The collected samples were placed in plastic bags, sealed, and shipped to an independent laboratory. A formal chain of custody procedure is maintained between ECOH and the sub-contracted laboratory during sample transport. All laboratories used by ECOH are accredited under the U.S. EPA National Environmental Lead Laboratory Accreditation Program (NLLAP) and/or American Industrial Hygiene Association (AIHA) Environmental Lead Laboratory Accreditation Program (ELLAP) to ensure consistent, accurate and defensible results.

Lead concentrations exceeding 1000ppm (0.1%) are considered to indicate the material is "lead-containing" per City of Toronto policy and applicable guidelines.

2.4 Mould Assessment

The mould assessment of the project area was conducted in accordance with the Canadian Construction Association, Standard Construction Document CCA 82, 2018; “*Mould Guidelines for the Canadian Construction Industry*”. Although there are no regulatory requirements in Ontario for such an assessment, the preceding protocol has become accepted as the industry standard by most experts, consultants, and the Ontario Ministry of Labour.

2.5 Assessment for PCBs

The primary sources of PCBs in high concentrations in commercial facilities are ballasts in fluorescent or HID light fixtures, and electrical transformers.

Neither dismantling the lights to investigate the ballasts, nor dismantling the transformers to investigate their interiors, was part of the scope of this survey. A rough count of the number of fluorescent or HID light fixtures in the building was made and is presented in the findings. Without disassembly, it is impossible to determine whether the ballasts are PCB-containing, and therefore all such light fixtures are assumed to contain PCB ballasts.

Electrical transformers cannot be safely disassembled during a survey such as this. Determination of PCB content relies on the comparison of information on labels and nameplates located on the exterior of the transformer with standard PCB Identifier Code literature. Transformers must be assumed to contain PCB's if the results of that comparison do not clearly and specifically indicate the transformer does not contain PCB's.

2.6 Hazardous Materials Survey Inventory

ECOH's surveyor completed a mould, lead and asbestos field data sheet for each room entered. The data sheet contains the room name, a unique room number assigned by the surveyor, the quantity, type and condition of potentially hazardous materials present in the room, and sampling information. The inventory sheet is included as Appendix I.

2.7 Survey of Other Hazardous Materials

Materials or equipment suspected of containing other Designated Substances and/or PCBs are identified by appearance, age and knowledge of historic applications.

3. FINDINGS AND RECOMMENDATIONS

3.1 Asbestos

Confirmed ACM identified within the facility includes the following:

- Texture Coat (Friable).

Assumed ACM identified within the facility includes the following:

- Mastic (Non-friable),
- Levelling Compound (Non-friable),
- Drywall Joint Compound (Non-friable),
- Plaster (Non-friable),
- Window Caulking (Non-Friable), and
- Roofing Material (Non-friable).

The locations and quantities of materials assumed or confirmed to be asbestos-containing can be found in the hazardous materials inventory sheet, which is included as Appendix I.

No samples were collected for analysis of asbestos type and content during the current survey.

For the purposes of future renovation and/or demolition activities in specific locations within the facility, any building materials not specifically sampled in the project area should be treated as if their asbestos content is not known. Such materials should, therefore, be sampled prior the occurrence of renovation or demolition work.

Additional asbestos-containing materials may be present in areas of the building which were inaccessible at the time of the survey (ie. above fixed ceilings, behind walls, under flooring, etc.).

3.2 Lead

No potentially lead-containing materials were observed to be damaged during the survey, and, therefore, no samples of such materials were collected.

No significant potential sources of lead or lead-containing products were identified during the survey. However, lead may be present in:

- Wiring connectors and electric cable sheathing, and
- Piping and solder joints or bell joints on piping.

3.3 Mould

No mould-affected building materials were observed during the survey.

3.4 Mercury

Mercury is present in minor quantities within the project area in the following forms:

- As a vapour within fluorescent light tubes that are present in the project area,
- As a possible constituent of thermostats, and

- As a possible constituent of paints and adhesives.

Items suspected to contain mercury were noted to be in good condition.

3.5 Silica

Free crystalline silica, in the form of common construction sand, is present in all concrete and masonry products within the building.

3.6 Polychlorinated Biphenyls (PCBs)

The following potential sources of Polychlorinated Biphenyls (PCBs) were identified within the facility. Dismantling lights to investigate ballasts and/or dismantling transformers to investigate their contents, was not part of the scope of this survey. Therefore, the items listed below must be assumed to contain PCBs, unless specifically stated otherwise:

- Fluorescent light ballasts:
 - Approximately 500 fluorescent light fixtures are present throughout the facility. Ballasts within these fixtures are assumed to contain PCBs.

Additional mechanical equipment or components of mechanical equipment throughout the facility may contain PCBs. These may include, but are not limited to, electrical capacitors and electrical equipment containing capacitors, voltage regulators, switches, re-closers, bushings or electromagnets, cable insulation, heat transfer equipment, hydraulic equipment, vapour diffusion pumps, bridge bearings, and caulking and motor/hydraulic oils. A specific assessment prior to the removal of any mechanical equipment within the facility should be conducted to confirm if PCBs are present within the equipment.

3.7 Other Environmental Considerations

The environmental audit also included an investigation for the following compounds, none of which were found to be present:

- | | |
|-----------------------|--------------------------|
| • Acrylonitrile | • Ethylene Oxides |
| • Arsenic | • Isocyanates |
| • Benzene | • Vinyl Chloride Monomer |
| • Coke Oven Emissions | |

Please note: paint, adhesives and plastics present throughout the project area may contain trace amounts of Acrylonitrile, Arsenic, Benzene, Ethylene Oxides, Isocyanates, Lead, Mercury and Vinyl Chloride Monomer. However, none of these materials were observed in a hazardous or unsafe condition.

4. RECOMMENDATIONS

4.1 Asbestos

All assumed and/or confirmed ACM were observed to be in GOOD condition at the time of the reassessment. As such, no corrective actions are recommended at this time.

Ontario Ministry of Labour Regulation 278/05 requires that an Asbestos Management Program (AMP) be implemented as long as asbestos-containing materials are present (or assumed to be present) in a building. The AMP, original survey report and subsequent reassessment reports must be available at the work place, and must identify the type of asbestos, and where asbestos can be found on a room-by-room basis.

NOTE: Interpretation of all sources of asbestos-related information, including but not limited to the original asbestos survey report, asbestos reassessment reports, room-by-room survey data, survey drawings and reports from previous asbestos abatement projects, should be completed by a competent person trained in the historical application of asbestos in building materials, building design and preferably by a person with site-specific knowledge and/or experience.

Information contained within any of the above-noted sources may not relieve the Regulatory responsibility of building Owners, or project Employers/Constructors, to complete a detailed site inspection prior to commencement of a project.

This report should not be used as a substitute for a detailed site inspection to identify asbestos-containing building materials, which must be specifically tailored to the scope and nature of any given project, and completed prior to any maintenance, renovation or demolition work that may cause disturbance to building materials.

4.2 Lead

Renovation, demolition or general construction work involving the removal of materials containing only trace concentrations of lead (i.e. Concentrations below 0.1% (1000ppm) by dry weight) can be completed without lead specific safety precautions provided that:

- a) work does not include 'fume generating activities' (heat producing) such as welding, torching, burning, high temperature cutting, etc.,
- b) work does not include dust-generating activities such as grinding, cutting or chemical stripping,
- c) dust levels are maintained below $3\text{mg}/\text{m}^3$, and
- d) general health and safety construction procedures are implemented, which would include dust suppression methods, proper respiratory protection (minimum of a 1/2-face respirator) and protective clothing, as is appropriate for the work being completed.

Any work involving the disturbance of building materials assumed to contain lead (e.g. wiring connectors or electric cable sheathing) should be conducted following recommendations detailed within the Ministry of Labour document *Guideline - Lead on Construction Projects*, dated April 2011.

All lead-containing waste materials must be disposed of following requirements set forth in applicable federal and/or provincial regulations, including Ontario Regulation 347: *General – Waste Management*.

4.3 Mould

The removal of all mould-affected building materials should be conducted following recommendations detailed within the Canadian Construction Association, Standard Construction Document CCA 82, 2018; “*Mould Guidelines for the Canadian Construction Industry*” or the Environmental Abatement Council of Ontario (EACO) *Mould Abatement Guidelines*, Ed. 3 (2015).

4.4 Mercury

The presence of mercury within assembled units (e.g. fluorescent light bulbs and thermostat bulbs) should not be considered a hazard provided that the assembled units remain sealed and intact. Avoid direct skin contact with mercury and avoid inhalation of mercury vapour. If required, dispose of mercury following applicable legislative requirements.

4.5 Silica

Silica-containing building materials are present throughout the facility (e.g. concrete, brick, cement block, etc.). Any work involving the disturbance of materials that may contain silica should be conducted following recommendations detailed in the Ministry of Labour document “*Guideline - Silica on Construction Projects*”, dated September 2004.

4.6 Polychlorinated Biphenyls (PCBs)

Fluorescent light ballasts and other mechanical equipment throughout the facility are assumed to contain PCBs as dismantling the lights to investigate the ballasts was not part of the scope of this survey.

PCB-containing light ballasts may legally remain in use until December 31, 2025, if they were already in use in the facility on September 5, 2008. However, it is ECOH’s general recommendation that PCB ballasts are proactively removed to eliminate the possibility of ballasts rupturing and requiring costly remediation. To determine whether light ballasts contain PCBs, they should be disassembled to observe serial codes and then compared to standard PCB Identifier Code literature. Ballasts with unidentifiable serial codes, or from manufacturers

who are not included in the standard PCB Identifier Code literature, or which are not clearly labelled as “PCB Free”, or for which no date is clearly visible (ballasts dated 1981 or later do not contain PCBs), must be assumed to contain PCBs.

Disposal of fluorescent light ballasts that contain PCBs must follow Ontario Regulation 347, General –Waste Management, Ontario Regulation 362, Waste Management – PCB’s, and the amended PCB Regulations, 2008 established under the Canadian Environmental Protection Act, 1999.

Removal of any other PCB-containing substances or equipment in the facility should follow the amended *PCB Regulations*, 2008, made under the *Canadian Environmental Protection Act*, 1999 (CEPA).

4.7 Other Substances

Dust suppression and personal protection procedures should be implemented during the demolition of materials that may contain Acrylonitrile, Arsenic, Benzene, Ethylene Oxides, Isocyanates, and Vinyl Chloride.

5. CORRECTIVE ACTIONS

Corrective actions are not required.

6. STATEMENT OF LIMITATIONS

Due to the nature of building construction, some limitations exist as to the possible thoroughness of the designated substance and hazardous materials survey. The field observations, measurements and analysis are considered sufficient in detail and scope to form a reasonable basis for the findings and conclusions presented in this report. The findings and conclusions drawn by ECOH, concerning the designated substance and hazardous materials survey, are limited to the specific scope of work for which ECOH was retained and are based solely on information generated as a result of the specific scope of work authorized by The City of Toronto. The results of the designated substance and hazardous materials survey are limited to visual inspection of areas made accessible to ECOH personnel and information obtained from facility personnel, when obtained.

ECOH warrants that the findings and conclusions contained herein have been made in accordance with generally accepted evaluation methods in the industry and applicable regulations at the time of the performance of the designated substance survey. However, there is no warranty, expressed or implied, that this building survey has uncovered all environmental considerations on the subject site. In addition, ECOH cannot guarantee the completeness or accuracy of information supplied by a third party.

This report was prepared by ECOH for The City of Toronto. The material in it reflects ECOH's professional interpretation of information available at the time of report preparation. Any use which a third party makes of this report, or any reliance on or decisions to be made based on it, are the responsibility of such third parties.

ECOH

Environmental Consulting
Occupational Health

Prepared by:



Brittanie Semper
Senior Environmental Scientist

Reviewed by:



Naomi Pitcher, B.Env.Sc
Environmental Scientist

Reviewed by:



Marlene Lopes Jongsma, B.A. (ENV)
Project Manager

Reviewed by:



Steve Bizi
Project Manager

APPENDIX I

Hazardous Materials Inventory Sheet

APPENDIX I - HAZARDOUS MATERIALS INVENTORY SHEET

Building Address:	313 Pharmacy Avenue	Date(s) of Current Reassessment:	October 6, 2020
Building Name:	West Scarborough Neighbourhood Community Centre	Organization Completing Reassessment:	ECOH

Summary of Findings

Mastic is assumed to be present underneath existing Vinyl Floor Tiles and Vinyl Sheet Flooring throughout the facility. Complete sampling of mastic is recommended prior to any flooring renovations.

Location Number	Location Name	System	Material Observed	Potential Hazardous Material	Sample ID	Asbestos Type/Content	Quantity	Condition	Notes/Required Action
0-00	Exterior	Roof	Roofing Material	Asbestos	Not Sampled	ACM Assumed	N/A	N/A	
0-00	Exterior	Windows	Window Caulking	Asbestos	Not Sampled	ACM Assumed	N/A	N/A	
1-01	Boiler Room	Floor	Concrete	N/A	N/A	N/A	N/A	N/A	Water Meter Room
1-01	Boiler Room	Wall	Concrete Block	Asbestos	15207-03-B077-01A-C	None Detected	N/A	N/A	Sampled during ECOH 2015 DSS Survey
1-01	Boiler Room	Wall	Concrete Block	Lead	15207-03-B077-Pb-01,02	190 ppm, 57 ppm (NEGATIVE - Trace concentrations only)	N/A	N/A	Sampled during ECOH 2015 DSS Survey
1-01	Boiler Room	Ceiling	N/A	N/A	N/A	N/A	N/A	N/A	No False Ceiling
1-01	Boiler Room	Pipe	Fibreglass	N/A	N/A	N/A	N/A	N/A	
1-01	Boiler Room	Structure	Concrete	N/A	N/A	N/A	N/A	N/A	
1-02	Stairwell	Floor	Vinyl Floor Tile 1	Asbestos	Not Sampled	Visually consistent with 16608-B077-ASB-01 (None Detected)	N/A	N/A	12"x12" cream with brown specks NOT OBSERVED 2018
1-02	Stairwell	Floor	Terrazzo	N/A	N/A	N/A	N/A	N/A	
1-02	Stairwell	Wall	Drywall Joint Compound	Asbestos	Not Sampled	Visually Consistent with 15833-B077-ASB-01 16608-B077-ASB-13 (None Detected)	N/A	N/A	
1-02	Stairwell	Wall	Concrete	N/A	N/A	N/A	N/A	N/A	
1-02	Stairwell	Wall	Concrete Block	N/A	N/A	N/A	N/A	N/A	
1-02	Stairwell	Ceiling	Texture Coat	Asbestos	07-3464-05	1% Chrysotile	100 ft²	Good	From Fisher 2007 Reassessment Report (FE-P-3464)
1-02	Stairwell	Ceiling	Ceiling Tile 1	Asbestos	Not Sampled	Visually consistent with 16608-B077-ASB-08 (None Detected)	N/A	N/A	2'x4' Pinprick with fissure
1-03	Lounge	Floor	Vinyl Floor Tile 8	Asbestos	Not Sampled	ACM Assumed	N/A	N/A	White with black marks NOT OBSERVED 2018
1-03	Lounge	Floor	Ceramic Tile	Lead	N/A	Lead Assumed	N/A	N/A	
1-03	Lounge	Wall	Concrete Block	N/A	N/A	N/A	N/A	N/A	
1-03	Lounge	Ceiling	Ceiling Tile 1	Asbestos	Not Sampled	Visually consistent with 16608-B077-ASB-08 (None Detected)	N/A	N/A	2'x4' Pinprick with fissure NOT OBSERVED 2018
1-03	Lounge	Ceiling	Ceiling Tile 3	Asbestos	Not Sampled	Visually consistent with 16608-B077-ASB-10 (None Detected)	N/A	N/A	2'x4' long fissure
1-03	Lounge	Ceiling	Ceiling Tile 2	Asbestos	Not Sampled	Visually consistent with 16608-B077-ASB-09 (None Detected)	N/A	N/A	1'x1' glue-on with small, medium holes Above Ceiling
1-03	Lounge	Structure	Concrete	N/A	N/A	N/A	N/A	N/A	

APPENDIX I - HAZARDOUS MATERIALS INVENTORY SHEET

Location Number	Location Name	System	Material Observed	Potential Hazardous Material	Sample ID	Asbestos Type/Content	Quantity	Condition	Notes/Required Action
1-04A	Recreational Area	Floor	Vinyl Floor Tile 8	Asbestos	Not Sampled	ACM Assumed	N/A	N/A	White with black marks NOT OBSERVED 2018
1-04A	Recreational Area	Floor	Ceramic Tile	Lead	N/A	Lead Assumed	N/A	N/A	
1-04A	Recreational Area	Wall	Drywall Joint Compound	Asbestos	Not Sampled	Visually Consistent with 15833-B077-ASB-01 16608-B077-ASB-13 (None Detected)	N/A	N/A	
1-04A	Recreational Area	Wall	Concrete Block	N/A	N/A	N/A	N/A	N/A	
1-04A	Recreational Area	Ceiling	Texture Coat	Asbestos	Not Sampled	Visually Consistent with 07-3464-02, 05 (1% Chrysotile)	500 ft²	Good	
1-04B	Corridor	Floor	Ceramic Tile	Lead	N/A	Lead Assumed	N/A	N/A	
1-04B	Corridor	Wall	Concrete Block	N/A	N/A	N/A	N/A	N/A	
1-04B	Corridor	Ceiling	Drywall Joint Compound	Asbestos	Not Sampled	ACM Assumed	250 ft²	Good	above ceiling tiles
1-05	Office	Floor	Vinyl Floor Tile 8	Asbestos	Not Sampled	ACM Assumed	N/A	N/A	White with black marks NOT OBSERVED 2018
1-05	Office	Floor	Ceramic Tile	Lead	N/A	Lead Assumed	N/A	N/A	
1-05	Office	Wall	Drywall Joint Compound	Asbestos	Not Sampled	Visually Consistent with 15833-B077-ASB-01 16608-B077-ASB-13 (None Detected)	N/A	N/A	
1-05	Office	Wall	Concrete Block	N/A	N/A	N/A	N/A	N/A	
1-05	Office	Ceiling	Texture Coat	Asbestos	Not Sampled	Visually Consistent with 07-3464-02, 05 (1% Chrysotile)	150 ft²	Good	
1-06	Office	Floor	Vinyl Floor Tile 8	Asbestos	Not Sampled	ACM Assumed	N/A	N/A	White with black marks NOT OBSERVED 2018
1-06	Office	Floor	Ceramic Tile	Lead	N/A	Lead Assumed	N/A	N/A	
1-06	Office	Wall	Drywall Joint Compound	Asbestos	Not Sampled	Visually Consistent with 15833-B077-ASB-01 16608-B077-ASB-13 (None Detected)	N/A	N/A	
1-06	Office	Ceiling	Ceiling Tile 1	Asbestos	Not Sampled	Visually consistent with 16608-B077-ASB-08 (None Detected)	N/A	N/A	2'x4' Pinprick with fissure
1-07	Washroom	Floor	Ceramic Tile	Lead	N/A	Lead Assumed	N/A	N/A	
1-07	Washroom	Wall	Concrete Block	N/A	N/A	N/A	N/A	N/A	
1-07	Washroom	Ceiling	Drywall Joint Compound	Asbestos	Not Sampled	ACM Assumed	25 ft²	Good	above ceiling tiles
1-08	Janitor's Closet	Floor	Ceramic Tile	Lead	N/A	Lead Assumed	N/A	N/A	
1-08	Janitor's Closet	Wall	Drywall Joint Compound	Asbestos	Not Sampled	Visually Consistent with 15833-B077-ASB-01 16608-B077-ASB-13 (None Detected)	N/A	N/A	
1-08	Janitor's Closet	Wall	Concrete Block	N/A	N/A	N/A	N/A	N/A	
1-08	Janitor's Closet	Ceiling	Texture Coat	Asbestos	Not Sampled	Visually Consistent with 07-3464-02, 05 (1% Chrysotile)	20 ft²	Good	above ceiling tiles

APPENDIX I - HAZARDOUS MATERIALS INVENTORY SHEET

Location Number	Location Name	System	Material Observed	Potential Hazardous Material	Sample ID	Asbestos Type/Content	Quantity	Condition	Notes/Required Action
1-08	Janitor's Closet	Ceiling	Ceiling Tile 1	Asbestos	Not Sampled	Visually consistent with 16608-B077-ASB-08 (None Detected)	N/A	N/A	2'x4' Pinprick with fissure
1-09	Maintenance Room	Floor	Concrete	N/A	N/A	N/A	N/A	N/A	
1-09	Maintenance Room	Wall	Drywall Joint Compound	Asbestos	Not Sampled	Visually Consistent with 15833-B077-ASB-01 16608-B077-ASB-13 (None Detected)	N/A	N/A	
1-09	Maintenance Room	Wall	Concrete Block	N/A	N/A	N/A	N/A	N/A	
1-09	Maintenance Room	Pipe	Fibreglass	N/A	N/A	N/A	N/A	N/A	
1-09	Maintenance Room	Ceiling	Concrete	N/A	N/A	N/A	N/A	N/A	
1-10a	Craft Room	Floor	Vinyl Floor Tile 8	Asbestos	Not Sampled	ACM Assumed	N/A	N/A	White with black marks NOT OBSERVED 2018
1-10a	Craft Room	Floor	Ceramic Tile	Lead	N/A	Lead Assumed	N/A	N/A	
1-10a	Craft Room	Wall	Drywall Joint Compound	Asbestos	Not Sampled	Visually Consistent with 15833-B077-ASB-01 16608-B077-ASB-13 (None Detected)	N/A	N/A	
1-10a	Craft Room	Ceiling	Ceiling Tile 1	Asbestos	Not Sampled	Visually consistent with 16608-B077-ASB-08 (None Detected)	N/A	N/A	2'x4' Pinprick with fissure
1-10b	Office	Floor	Ceramic Tile	Lead	N/A	Lead Assumed	N/A	N/A	
1-10b	Office	Wall	Concrete Block	N/A	N/A	N/A	N/A	N/A	
1-10b	Office	Wall	Drywall Joint Compound	Asbestos	Not Sampled	Visually Consistent with 15833-B077-ASB-01 16608-B077-ASB-13 (None Detected)	N/A	N/A	
1-10b	Office	Ceiling	Ceiling Tile 1	Asbestos	Not Sampled	Visually consistent with 16608-B077-ASB-08 (None Detected)	N/A	N/A	2'x4' Pinprick with fissure
1-11	Stairway	Floor	Concrete	N/A	N/A	N/A	N/A	N/A	
1-11	Stairway	Wall	Concrete Block	N/A	N/A	N/A	N/A	N/A	
1-11	Stairway	Wall	Drywall Joint Compound	Asbestos	16608-B077-ASB-13A	None Detected	N/A	N/A	Sampled during ECOH 2016 Reassessment Survey
1-11	Stairway	Ceiling	Ceiling Tile 1	Asbestos	Not Sampled	Visually consistent with 16608-B077-ASB-08 (None Detected)	N/A	N/A	2'x4' Pinprick with fissure
1-12	Storage	Floor	Concrete	N/A	N/A	N/A	N/A	N/A	
1-12	Storage	Wall	Paint - White	Lead	15170-B077-Pb-01A,B	70 ppm (NEGATIVE - Trace concentrations only)	N/A	N/A	
1-12	Storage	Wall	Drywall Joint Compound	Asbestos	Not Sampled	Visually Consistent with 15833-B077-ASB-01 16608-B077-ASB-13 (None Detected)	N/A	N/A	
1-12	Storage	Ceiling	Texture Coat	Asbestos	Not Sampled	Visually Consistent with 07-3464-02, 05 (1% Chrysotile)	75 ft²	Good	

APPENDIX I - HAZARDOUS MATERIALS INVENTORY SHEET

Location Number	Location Name	System	Material Observed	Potential Hazardous Material	Sample ID	Asbestos Type/Content	Quantity	Condition	Notes/Required Action
1-13	Gym	Floor	Vinyl Floor Tile 3	Asbestos	16608-B077-ASB-03A-C	None Detected	N/A	N/A	12"x12" multi-coloured Sampled during ECOH 2016 Reassessment Survey
1-13	Gym	Floor	Vinyl Floor Tile 2	Asbestos	16608-B077-ASB-02A-C	None Detected	N/A	N/A	12"x12" White with Yellow Marks Sampled during ECOH 2016 Reassessment Survey
1-13	Gym	Floor	Mastic - VFT2	Asbestos	16608-B077-ASB-02A-C	None Detected	N/A	N/A	Sampled during ECOH 2016 Reassessment Survey
1-13	Gym	Floor	Leveler - VFT2	Asbestos	16608-B077-ASB-02A-C	None Detected	N/A	N/A	Sampled during ECOH 2016 Reassessment Survey
1-13	Gym	Wall	Concrete Block	N/A	N/A	N/A	N/A	N/A	
1-13	Gym	Ceiling	Plaster	Asbestos	Not Sampled	ACM Assumed	3000 ft²	Good	too high to sample
1-13	Gym	Ceiling	Texture Coat	Asbestos	Not Sampled	Visually Consistent with 07-3464-02, 05 (1%Chrysotile)	150 ft²	Good	
1-14	Storage	Floor	Concrete	N/A	N/A	N/A	N/A	N/A	
1-14	Storage	Wall	Concrete Block	N/A	N/A	N/A	N/A	N/A	
1-14	Storage	Ceiling	N/A	N/A	N/A	N/A	N/A	N/A	No False Ceiling
1-14	Storage	Duct	Tar	Asbestos	Not Sampled	ACM Assumed	N/A	N/A	Brown NOT OBSERVED 2018
1-14	Storage	Pipe	Fibreglass	N/A	N/A	N/A	N/A	N/A	
1-14	Storage	Structure	Concrete	N/A	N/A	N/A	N/A	N/A	
1-15	N/A	N/A	N/A	N/A	N/A	N/A	N/A	N/A	Location Number No Longer in Use
1-16	Women's Change Room	Floor	Vinyl Sheet Flooring 3	Asbestos	Not Sampled	ACM Assumed	N/A	N/A	NOT OBSERVED 2018
1-16	Women's Change Room	Floor	Terrazzo	N/A	N/A	N/A	N/A	N/A	
1-16	Women's Change Room	Wall	Concrete Block	N/A	N/A	N/A	N/A	N/A	
1-16	Women's Change Room	Ceiling	Texture Coat	Asbestos	Not Sampled	Visually Consistent with 07-3464-02, 05 (1%Chrysotile)	700 ft²	Good	
1-17	Storage	Floor	Vinyl Sheet Flooring 3	Asbestos	Not Sampled	ACM Assumed	N/A	N/A	NOT OBSERVED 2018
1-17	Storage	Floor	Terrazzo	N/A	N/A	N/A	N/A	N/A	
1-17	Storage	Wall	Concrete Block	N/A	N/A	N/A	N/A	N/A	
1-17	Storage	Ceiling	Texture Coat	Asbestos	07-3464-02	1%Chrysotile	125 ft²	Good	From Fisher 2007 Reassessment Report (FE-P-3464)
1-18	Men's Change Room	Floor	Vinyl Sheet Flooring 3	Asbestos	Not Sampled	ACM Assumed	N/A	N/A	NOT OBSERVED 2018
1-18	Men's Change Room	Floor	Terrazzo	N/A	N/A	N/A	N/A	N/A	
1-18	Men's Change Room	Wall	Concrete Block	N/A	N/A	N/A	N/A	N/A	
1-18	Men's Change Room	Ceiling	Texture Coat	Asbestos	Not Sampled	Visually Consistent with 07-3464-02, 05 (1%Chrysotile)	700 ft²	Good	

APPENDIX I - HAZARDOUS MATERIALS INVENTORY SHEET

Location Number	Location Name	System	Material Observed	Potential Hazardous Material	Sample ID	Asbestos Type/Content	Quantity	Condition	Notes/Required Action
1-19	Pool Office	Floor	Vinyl Sheet Flooring 3	Asbestos	Not Sampled	ACM Assumed	N/A	N/A	NOT OBSERVED 2018
1-19	Pool Office	Floor	Terrazzo	N/A	N/A	N/A	N/A	N/A	
1-19	Pool Office	Wall	Concrete Block	N/A	N/A	N/A	N/A	N/A	
1-19	Pool Office	Ceiling	Texture Coat	Asbestos	Not Sampled	Visually Consistent with 07-3464-02, 05 (1% Chrysotile)	60 ft²	Good	
1-20	Pool	Floor	Ceramic Tile	Lead	N/A	Lead Assumed	N/A	N/A	
1-20	Pool	Wall	Concrete Block	N/A	N/A	N/A	N/A	N/A	
1-20	Pool	Ceiling	Plaster	Asbestos	Not Sampled	ACM Assumed	3000 ft²	Good	too high to sample
1-20	Pool	Ceiling	Texture Coat	Asbestos	Not Sampled	Visually Consistent with 07-3464-02, 05 (1% Chrysotile)	200 ft²	Good	
1-20	Pool	Structure	Steel	N/A	N/A	N/A	N/A	N/A	
1-21	Storage	Floor	Concrete	N/A	N/A	N/A	N/A	N/A	
1-21	Storage	Wall	Concrete Block	N/A	N/A	N/A	N/A	N/A	
1-21	Storage	Ceiling	Wood	N/A	N/A	N/A	N/A	N/A	
1-21	Storage	Pipe	Fibreglass	N/A	N/A	N/A	N/A	N/A	
1-22	Conference Room	Floor	Hardwood	N/A	N/A	N/A	N/A	N/A	
1-22	Conference Room	Ceiling	Ceiling Tile 2	Asbestos	Not Sampled	Visually consistent with 16608-B077-ASB-09 (None Detected)	N/A	N/A	1'x1' glue-on with small, medium holes
1-22	Conference Room	Wall	Drywall Joint Compound	Asbestos	Not Sampled	ACM Assumed	N/A	N/A	NOT OBSERVED 2018
1-22	Conference Room	Wall	Concrete Block	N/A	N/A	N/A	N/A	N/A	
1-23a	Atrium	Floor	Terrazzo	N/A	N/A	N/A	N/A	N/A	
1-23a	Atrium	Wall	Drywall Joint Compound	Asbestos	Not Sampled	Visually Consistent with 15833-B077-ASB-01 16608-B077-ASB-13 (None Detected)	N/A	N/A	
1-23a	Atrium	Wall	Concrete Block	N/A	N/A	N/A	N/A	N/A	
1-23a	Atrium	Ceiling	Ceiling Tile 2	Asbestos	16608-B077-ASB-09A-C	None Detected	N/A	N/A	1'x1' glue-on with small, medium holes Sampled during ECOH 2016 Reassessment Survey
1-23b	East Corridor	Floor	Vinyl Floor Tile 5	Asbestos	Not Sampled	Visually consistent with 16608-B077-ASB-05 (None Detected)	N/A	N/A	12"x12" Light Brown with Streaks
1-23b	East Corridor	Wall	Drywall Joint Compound	Asbestos	15833-B077-ASB-01A-C 16608-B077-ASB-13B,C	None Detected None Detected	N/A	N/A	Sampled during ECOH 2015 Reassessment Survey Sampled during ECOH 2016 Reassessment Survey
1-23b	East Corridor	Ceiling	Ceiling Tile 3	Asbestos	Not Sampled	Visually consistent with 16608-B077-ASB-10 (None Detected)	N/A	N/A	2'x4' long fissure

APPENDIX I - HAZARDOUS MATERIALS INVENTORY SHEET

Location Number	Location Name	System	Material Observed	Potential Hazardous Material	Sample ID	Asbestos Type/Content	Quantity	Condition	Notes/Required Action
1-23c	West Corridor	Floor	Vinyl Sheet Flooring 3	Asbestos	Not Sampled	ACM Assumed	N/A	N/A	NOT OBSERVED 2018
1-23c	West Corridor	Floor	Terrazzo	N/A	N/A	N/A	N/A	N/A	
1-23c	West Corridor	Wall	Concrete Block	N/A	N/A	N/A	N/A	N/A	
1-23c	West Corridor	Ceiling	Drywall Joint Compound	Asbestos	Not Sampled	ACM Assumed	100 ft²	Good	above ceiling tiles
1-23d	Corridor	Floor	Vinyl Sheet Flooring 3	Asbestos	Not Sampled	ACM Assumed	N/A	N/A	NOT OBSERVED 2018
1-23d	Corridor	Floor	Terrazzo	N/A	N/A	N/A	N/A	N/A	
1-23d	Corridor	Wall	Drywall Joint Compound	Asbestos	Not Sampled	Visually Consistent with 15833-B077-ASB-01 16608-B077-ASB-13 (None Detected)	N/A	N/A	NOT OBSERVED 2018
1-23d	Corridor	Wall	Concrete Block	N/A	N/A	N/A	N/A	N/A	
1-23d	Corridor	Ceiling	Texture Coat	Asbestos	Not Sampled	Visually Consistent with 07-3464-02, 05 (1% Chrysotile)	N/A	N/A	NOT OBSERVED 2018
1-23d	Corridor	Ceiling	Drywall Joint Compound	Asbestos	Not Sampled	ACM Assumed	75 ft²	Good	above ceiling tiles
1-24	Activity Room	Floor	Vinyl Floor Tile 4	Asbestos	16608-B077-ASB-04A-C	None Detected	N/A	N/A	12"x12" Blue with white marks Sampled during ECOH 2016 Reassessment Survey
1-24	Activity Room	Floor	Mastic - VFT4	Asbestos	16608-B077-ASB-04b,c	ACM Assumed	1000 ft²	Good	Insufficient samples analysed to meet regulatory requirements Sampled during ECOH 2016 Reassessment Survey
1-24	Activity Room	Wall	Drywall Joint Compound	Asbestos	Not Sampled	Visually Consistent with 15833-B077-ASB-01 16608-B077-ASB-13 (None Detected)	N/A	N/A	
1-24	Activity Room	Wall	Concrete Block	N/A	N/A	N/A	N/A	N/A	
1-24	Activity Room	Ceiling	N/A	N/A	N/A	N/A	N/A	N/A	No False Ceiling
1-24	Activity Room	Structure	Wood	N/A	N/A	N/A	N/A	N/A	
1-25	Lounge	Floor	Vinyl Floor Tile 5	Asbestos	16608-B077-ASB-05A-C	None Detected	N/A	N/A	12"x12" Light Brown with Streaks Sampled during ECOH 2016 Reassessment Survey
1-25	Lounge	Floor	Mastic - VFT5	Asbestos	16608-B077-ASB-05a-c	None Detected	N/A	N/A	Sampled during ECOH 2016 Reassessment Survey
1-25	Lounge	Wall	Concrete Block	N/A	N/A	N/A	N/A	N/A	
1-25	Lounge	Wall	Drywall Joint Compound	Asbestos	Not Sampled	Visually Consistent with 15833-B077-ASB-01 16608-B077-ASB-13 (None Detected)	N/A	N/A	
1-25	Lounge	Ceiling	Ceiling Tile 3	Asbestos	Not Sampled	Visually consistent with 16608-B077-ASB-10 (None Detected)	N/A	N/A	2'x4' long fissure
1-26	Kitchen	Floor	Vinyl Sheet Flooring 1	Asbestos	Not Sampled	Visually consistent with 16608-B077-ASB-11 (None Detected)	N/A	N/A	Peach with black dots
1-26	Kitchen	Wall	Concrete Block	N/A	N/A	N/A	N/A	N/A	
1-26	Kitchen	Ceiling	Ceiling Tile 1	Asbestos	Not Sampled	Visually consistent with 16608-B077-ASB-08 (None Detected)	N/A	N/A	2'x4' Pinprick with fissure

APPENDIX I - HAZARDOUS MATERIALS INVENTORY SHEET

Location Number	Location Name	System	Material Observed	Potential Hazardous Material	Sample ID	Asbestos Type/Content	Quantity	Condition	Notes/Required Action
1-27	Office	Floor	Vinyl Floor Tile 5	Asbestos	Not Sampled	Visually consistent with 16608-B077-ASB-05 (None Detected)	N/A	N/A	12"x12" Light Brown with Streaks
1-27	Office	Wall	Concrete Block	N/A	N/A	N/A	N/A	N/A	
1-27	Office	Ceiling	Ceiling Tile 3	Asbestos	Not Sampled	Visually consistent with 16608-B077-ASB-10 (None Detected)	N/A	N/A	2'x4' long fissure
1-27	Office	Ceiling	Ceiling Tile 2	Asbestos	Not Sampled	Visually consistent with 16608-B077-ASB-09 (None Detected)	N/A	N/A	1'x1' glue-on with small, medium holes Above Ceiling
1-28	Washroom	Floor	Vinyl Sheet Flooring 1	Asbestos	Not Sampled	Visually consistent with 16608-B077-ASB-11 (None Detected)	N/A	N/A	Peach with black dots
1-28	Washroom	Wall	Concrete Block	N/A	N/A	N/A	N/A	N/A	
1-28	Washroom	Ceiling	Ceiling Tile 3	Asbestos	Not Sampled	Visually consistent with 16608-B077-ASB-10 (None Detected)	N/A	N/A	2'x4' long fissure
1-29a	Photocopy Room	Floor	Vinyl Floor Tile 5	Asbestos	Not Sampled	Visually consistent with 16608-B077-ASB-05 (None Detected)	N/A	N/A	12"x12" Light Brown with Streaks
1-29a	Photocopy Room	Wall	Drywall Joint Compound	Asbestos	Not Sampled	Visually Consistent with 15833-B077-ASB-01 16608-B077-ASB-13 (None Detected)	N/A	N/A	
1-29a	Photocopy Room	Ceiling	Ceiling Tile 3	Asbestos	Not Sampled	Visually consistent with 16608-B077-ASB-10 (None Detected)	N/A	N/A	2'x4' long fissure
1-29b	Janitor's Closet	Floor	Vinyl Sheet Flooring 2	Asbestos	16608-B077-ASB-12A-C	None Detected	N/A	N/A	Black, Sparkly Sampled during ECOH 2016 Reassessment Survey
1-29b	Janitor's Closet	Wall	Concrete Block	N/A	N/A	N/A	N/A	N/A	
1-29b	Janitor's Closet	Wall	Drywall Joint Compound	Asbestos	Not Sampled	Visually Consistent with 15833-B077-ASB-01 16608-B077-ASB-13 (None Detected)	N/A	N/A	
1-29b	Janitor's Closet	Ceiling	Ceiling Tile 3	Asbestos	16608-B077-ASB-10A-C	None Detected	N/A	N/A	2'x4' long fissure Sampled during ECOH 2016 Reassessment Survey
1-29c	Storage	Floor	Vinyl Floor Tile 5	Asbestos	Not Sampled	Visually consistent with 16608-B077-ASB-05 (None Detected)	N/A	N/A	12"x12" Light Brown with Streaks
1-29c	Storage	Wall	Concrete Block	N/A	N/A	N/A	N/A	N/A	
1-29c	Storage	Ceiling	Ceiling Tile 3	Asbestos	Not Sampled	Visually consistent with 16608-B077-ASB-10 (None Detected)	N/A	N/A	2'x4' long fissure
1-30a	Office	Floor	Vinyl Floor Tile 7	Asbestos	16608-B077-ASB-07A-C	None Detected	N/A	N/A	12"x12" White with black marks Sampled during ECOH 2016 Reassessment Survey
1-30a	Office	Floor	Mastic - VFT7	Asbestos	16608-B077-ASB-07c	ACM Assumed	125 ft²	Good	Insufficient samples analyzed to meet regulatory requirements Sampled during ECOH 2016 Reassessment Survey
1-30a	Office	Floor	Leveler - VFT7	Asbestos	16608-B077-ASB-07a	ACM Assumed	125 ft²	Good	Insufficient samples analyzed to meet regulatory requirements Sampled during ECOH 2016 Reassessment Survey
1-30a	Office	Wall	Concrete Block	N/A	N/A	N/A	N/A	N/A	
1-30a	Office	Wall	Wood Panel	N/A	N/A	N/A	N/A	N/A	
1-30a	Office	Ceiling	Ceiling Tile 2	Asbestos	Not Sampled	Visually consistent with 16608-B077-ASB-09 (None Detected)	N/A	N/A	1'x1' glue-on with small, medium holes

APPENDIX I - HAZARDOUS MATERIALS INVENTORY SHEET

Location Number	Location Name	System	Material Observed	Potential Hazardous Material	Sample ID	Asbestos Type/Content	Quantity	Condition	Notes/Required Action
1-30b	Office	Floor	Vinyl Floor Tile 7	Asbestos	Not Sampled	Visually consistent with 16608-B077-ASB-07 (None Detected)	N/A	N/A	12"x12" White with black marks
1-30b	Office	Wall	Concrete Block	N/A	N/A	N/A	N/A	N/A	
1-30b	Office	Wall	Wood Panel	N/A	N/A	N/A	N/A	N/A	
1-30b	Office	Ceiling	Ceiling Tile 2	Asbestos	Not Sampled	Visually consistent with 16608-B077-ASB-09 (None Detected)	N/A	N/A	1'x1' glue-on with small, medium holes
1-31	Office	Floor	Vinyl Floor Tile 7	Asbestos	Not Sampled	Visually consistent with 16608-B077-ASB-07 (None Detected)	N/A	N/A	12"x12" White with black marks
1-31	Office	Wall	Concrete Block	N/A	N/A	N/A	N/A	N/A	
1-31	Office	Ceiling	Ceiling Tile 1	Asbestos	Not Sampled	Visually consistent with 16608-B077-ASB-08 (None Detected)	N/A	N/A	2'x4' Pinprick with fissure
1-32	Office	Floor	Vinyl Floor Tile 7	Asbestos	Not Sampled	Visually consistent with 16608-B077-ASB-07 (None Detected)	N/A	N/A	12"x12" White with black marks
1-32	Office	Wall	Concrete Block	N/A	N/A	N/A	N/A	N/A	
1-32	Office	Ceiling	Ceiling Tile 2	Asbestos	Not Sampled	Visually consistent with 16608-B077-ASB-09 (None Detected)	N/A	N/A	1'x1' glue-on with small, medium holes
1-33	Men's Washroom	Floor	Vinyl Sheet Flooring 1	Asbestos	Not Sampled	Visually consistent with 16608-B077-ASB-11 (None Detected)	N/A	N/A	Peach with black dots NOT OBSERVED 2018
1-33	Men's Washroom	Floor	Terrazzo	N/A	N/A	N/A	N/A	N/A	
1-33	Men's Washroom	Floor	Vinyl Floor Tile 6	Asbestos	Not Sampled	Visually consistent with 16608-B077-ASB-06 (None Detected)	N/A	N/A	12"x12" black
1-33	Men's Washroom	Wall	Concrete Block	N/A	N/A	N/A	N/A	N/A	
1-33	Men's Washroom	Ceiling	Ceiling Tile 3	Asbestos	Not Sampled	Visually consistent with 16608-B077-ASB-10 (None Detected)	N/A	N/A	2'x4' long fissure
1-33b	Electrical Room	Floor	Vinyl Floor Tile 5	Asbestos	Not Sampled	Visually consistent with 16608-B077-ASB-05 (None Detected)	N/A	N/A	12"x12" Light Brown with Streaks
1-33b	Electrical Room	Wall	Drywall Joint Compound	Asbestos	Not Sampled	Visually Consistent with 15833-B077-ASB-01 16608-B077-ASB-13 (None Detected)	N/A	N/A	
1-33b	Electrical Room	Ceiling	Ceiling Tile 3	Asbestos	Not Sampled	Visually consistent with 16608-B077-ASB-10 (None Detected)	N/A	N/A	2'x4' long fissure
1-34	Women's Washroom	Floor	Vinyl Sheet Flooring 1	Asbestos	Not Sampled	Visually consistent with 16608-B077-ASB-11 (None Detected)	N/A	N/A	Peach with black dots NOT OBSERVED 2018
1-34	Women's Washroom	Floor	Vinyl Floor Tile 6	Asbestos	16608-B077-ASB-06A-C	None Detected	N/A	N/A	12"x12" black Sampled during ECOH 2016 Reassessment Survey
1-34	Women's Washroom	Floor	Mastic - VFT6	Asbestos	16608-B077-ASB-06a-c	None Detected	N/A	N/A	Sampled during ECOH 2016 Reassessment Survey
1-34	Women's Washroom	Wall	Concrete Block	N/A	N/A	N/A	N/A	N/A	
1-34	Women's Washroom	Ceiling	Ceiling Tile 3	Asbestos	Not Sampled	Visually consistent with 16608-B077-ASB-10 (None Detected)	N/A	N/A	2'x4' long fissure

APPENDIX I - HAZARDOUS MATERIALS INVENTORY SHEET

Location Number	Location Name	System	Material Observed	Potential Hazardous Material	Sample ID	Asbestos Type/Content	Quantity	Condition	Notes/Required Action
1-35	Corridor	Floor	Vinyl Floor Tile 1	Asbestos	16608-B077-ASB-01A-C	None Detected	N/A	N/A	12"x12" cream with brown specks Sampled during ECHO 2016 Reassessment Survey
1-35	Corridor	Floor	Mastic - VFT1	Asbestos	16608-B077-ASB-01b	ACM Assumed	200 ft²	Unknown	Insufficient samples analyzed to meet regulatory requirements Sampled during ECHO 2016 Reassessment Survey NOT OBSERVED 2018
1-35	Corridor	Wall	Concrete Block	N/A	N/A	N/A	N/A	N/A	
1-35	Corridor	Ceiling	Ceiling Tile 1	Asbestos	Not Sampled	Visually consistent with 16608-B077-ASB-08 (None Detected)	N/A	N/A	2'x4' Pinprick with fissure
1-36	Office	Floor	Vinyl Floor Tile 1	Asbestos	Not Sampled	Visually consistent with 16608-B077-ASB-01 (None Detected)	N/A	N/A	12"x12" cream with brown specks
1-36	Office	Wall	Concrete Block	N/A	N/A	N/A	N/A	N/A	
1-36	Office	Ceiling	Ceiling Tile 1	Asbestos	Not Sampled	Visually consistent with 16608-B077-ASB-08 (None Detected)	N/A	N/A	2'x4' Pinprick with fissure
1-37	Office	Floor	Vinyl Floor Tile 1	Asbestos	Not Sampled	Visually consistent with 16608-B077-ASB-01 (None Detected)	N/A	N/A	12"x12" cream with brown specks
1-37	Office	Wall	Concrete Block	N/A	N/A	N/A	N/A	N/A	
1-37	Office	Wall	Drywall Joint Compound	Asbestos	Not Sampled	Visually Consistent with 15833-B077-ASB-01 16608-B077-ASB-13 (None Detected)	N/A	N/A	
1-37	Office	Ceiling	Ceiling Tile 1	Asbestos	Not Sampled	Visually consistent with 16608-B077-ASB-08 (None Detected)	N/A	N/A	2'x4' Pinprick with fissure
1-38	Office	Floor	Vinyl Floor Tile 1	Asbestos	Not Sampled	Visually consistent with 16608-B077-ASB-01 (None Detected)	N/A	N/A	12"x12" cream with brown specks
1-38	Office	Wall	Concrete Block	N/A	N/A	N/A	N/A	N/A	
1-38	Office	Wall	Drywall Joint Compound	Asbestos	Not Sampled	Visually Consistent with 15833-B077-ASB-01 16608-B077-ASB-13 (None Detected)	N/A	N/A	
1-38	Office	Ceiling	Ceiling Tile 1	Asbestos	Not Sampled	Visually consistent with 16608-B077-ASB-08 (None Detected)	N/A	N/A	2'x4' Pinprick with fissure
1-39	Office	Floor	Vinyl Floor Tile 1	Asbestos	Not Sampled	Visually consistent with 16608-B077-ASB-01 (None Detected)	N/A	N/A	12"x12" cream with brown specks
1-39	Office	Wall	Concrete Block	N/A	N/A	N/A	N/A	N/A	
1-39	Office	Ceiling	Ceiling Tile 1	Asbestos	Not Sampled	Visually consistent with 16608-B077-ASB-08 (None Detected)	N/A	N/A	2'x4' Pinprick with fissure
1-40	Women's Washroom	Floor	Vinyl Sheet Flooring 1	Asbestos	16608-B077-ASB-11A-C	None Detected	N/A	N/A	Peach with black dots Sampled during ECHO 2016 Reassessment Survey
1-40	Women's Washroom	Floor	Mastic - VSF1	Asbestos	16608-B077-ASB-11a-c	None Detected	N/A	N/A	Sampled during ECHO 2016 Reassessment Survey
1-40	Women's Washroom	Wall	Concrete Block	N/A	N/A	N/A	N/A	N/A	
1-40	Women's Washroom	Ceiling	Ceiling Tile 1	Asbestos	Not Sampled	Visually consistent with 16608-B077-ASB-08 (None Detected)	N/A	N/A	2'x4' Pinprick with fissure

APPENDIX I - HAZARDOUS MATERIALS INVENTORY SHEET

Location Number	Location Name	System	Material Observed	Potential Hazardous Material	Sample ID	Asbestos Type/Content	Quantity	Condition	Notes/Required Action
1-41	Men's Washroom	Floor	Vinyl Sheet Flooring 1	Asbestos	Not Sampled	Visually consistent with 16608-B077-ASB-11 (None Detected)	N/A	N/A	Peach with black dots
1-41	Men's Washroom	Wall	Concrete Block	N/A	N/A	N/A	N/A	N/A	
1-41	Men's Washroom	Ceiling	Ceiling Tile 1	Asbestos	Not Sampled	Visually consistent with 16608-B077-ASB-08 (None Detected)	N/A	N/A	2'x4' Pinprick with fissure
1-42	Computer Training Room	Floor	Vinyl Floor Tile 1	Asbestos	Not Sampled	Visually consistent with 16608-B077-ASB-01 (None Detected)	N/A	N/A	12"x12" cream with brown specks
1-42	Computer Training Room	Wall	Concrete Block	N/A	N/A	N/A	N/A	N/A	
1-42	Computer Training Room	Wall	Wood Board	N/A	N/A	N/A	N/A	N/A	
1-42	Computer Training Room	Ceiling	Ceiling Tile 1	Asbestos	Not Sampled	Visually consistent with 16608-B077-ASB-08 (None Detected)	N/A	N/A	2'x4' Pinprick with fissure
1-43	Office	Floor	Vinyl Floor Tile 1	Asbestos	Not Sampled	Visually consistent with 16608-B077-ASB-01 (None Detected)	N/A	N/A	12"x12" cream with brown specks
1-43	Office	Wall	Drywall Joint Compound	Asbestos	Not Sampled	Visually Consistent with 15833-B077-ASB-01 16608-B077-ASB-13 (None Detected)	N/A	N/A	
1-43	Office	Wall	Concrete Block	N/A	N/A	N/A	N/A	N/A	
1-43	Office	Ceiling	Ceiling Tile 1	Asbestos	Not Sampled	Visually consistent with 16608-B077-ASB-08 (None Detected)	N/A	N/A	2'x4' Pinprick with fissure
1-44	Office	Floor	Vinyl Floor Tile 1	Asbestos	Not Sampled	Visually consistent with 16608-B077-ASB-01 (None Detected)	N/A	N/A	12"x12" cream with brown specks
1-44	Office	Wall	Concrete Block	N/A	N/A	N/A	N/A	N/A	
1-44	Office	Ceiling	Ceiling Tile 1	Asbestos	Not Sampled	Visually consistent with 16608-B077-ASB-08 (None Detected)	N/A	N/A	2'x4' Pinprick with fissure
1-45	Arts and Crafts Rooms	Floor	Vinyl Floor Tile 1	Asbestos	Not Sampled	Visually consistent with 16608-B077-ASB-01 (None Detected)	N/A	N/A	12"x12" cream with brown specks
1-45	Arts and Crafts Rooms	Wall	Concrete Block	N/A	N/A	N/A	N/A	N/A	
1-45	Arts and Crafts Rooms	Ceiling	Ceiling Tile 1	Asbestos	16608-B077-ASB-08A-C	None Detected	N/A	N/A	2'x4' Pinprick with fissure Sampled during ECOH 2016 Reassessment Survey
1-46	Gym Balcony	Floor	Concrete	N/A	N/A	N/A	N/A	N/A	
1-46	Gym Balcony	Wall	Concrete Block	N/A	N/A	N/A	N/A	N/A	
1-46	Gym Balcony	Ceiling	N/A	N/A	N/A	N/A	N/A	N/A	No False Ceiling
1-46	Gym Balcony	Structure	Steel	N/A	N/A	N/A	N/A	N/A	

APPENDIX I - HAZARDOUS MATERIALS INVENTORY SHEET

Location Number	Location Name	System	Material Observed	Potential Hazardous Material	Sample ID	Asbestos Type/Content	Quantity	Condition	Notes/Required Action
1-47	Pool Viewing Area	Floor	Concrete	N/A	N/A	N/A	N/A	N/A	
1-47	Pool Viewing Area	Wall	Concrete Block	N/A	N/A	N/A	N/A	N/A	
1-47	Pool Viewing Area	Ceiling	N/A	N/A	N/A	N/A	N/A	N/A	No False Ceiling
1-48	Garbage Room	Floor	Concrete	N/A	N/A	N/A	N/A	N/A	
1-48	Garbage Room	Wall	Concrete Block	N/A	N/A	N/A	N/A	N/A	
1-48	Garbage Room	Ceiling	Concrete	N/A	N/A	N/A	N/A	N/A	No False Ceiling
Surveyor's Field Notes									



APPENDIX II

Results of Bulk Sample Analyses (No Information to Report)

APPENDIX III

Visually Identifiable Asbestos-Containing Material Info Sheet

APPENDIX III - VISUALLY IDENTIFIABLE ACM IDENTIFICATION SHEET

<i>MIN</i>	<i>Material</i>	<i>Photo</i>	<i>Material Description</i>	<i>Size (if applicable)</i>
VFT 4	Mastic		Blue with white marks (ACM Assumed)	12" x 12"
VFT 7	Mastic		Mastic beneath VFT - White with black marks (ACM Assumed)	12'x12'
VFT 7	Levelling Compound		Levelling compound beneath VFT - White with black marks (ACM Assumed)	12'x12'

APPENDIX IV

Survey Drawings

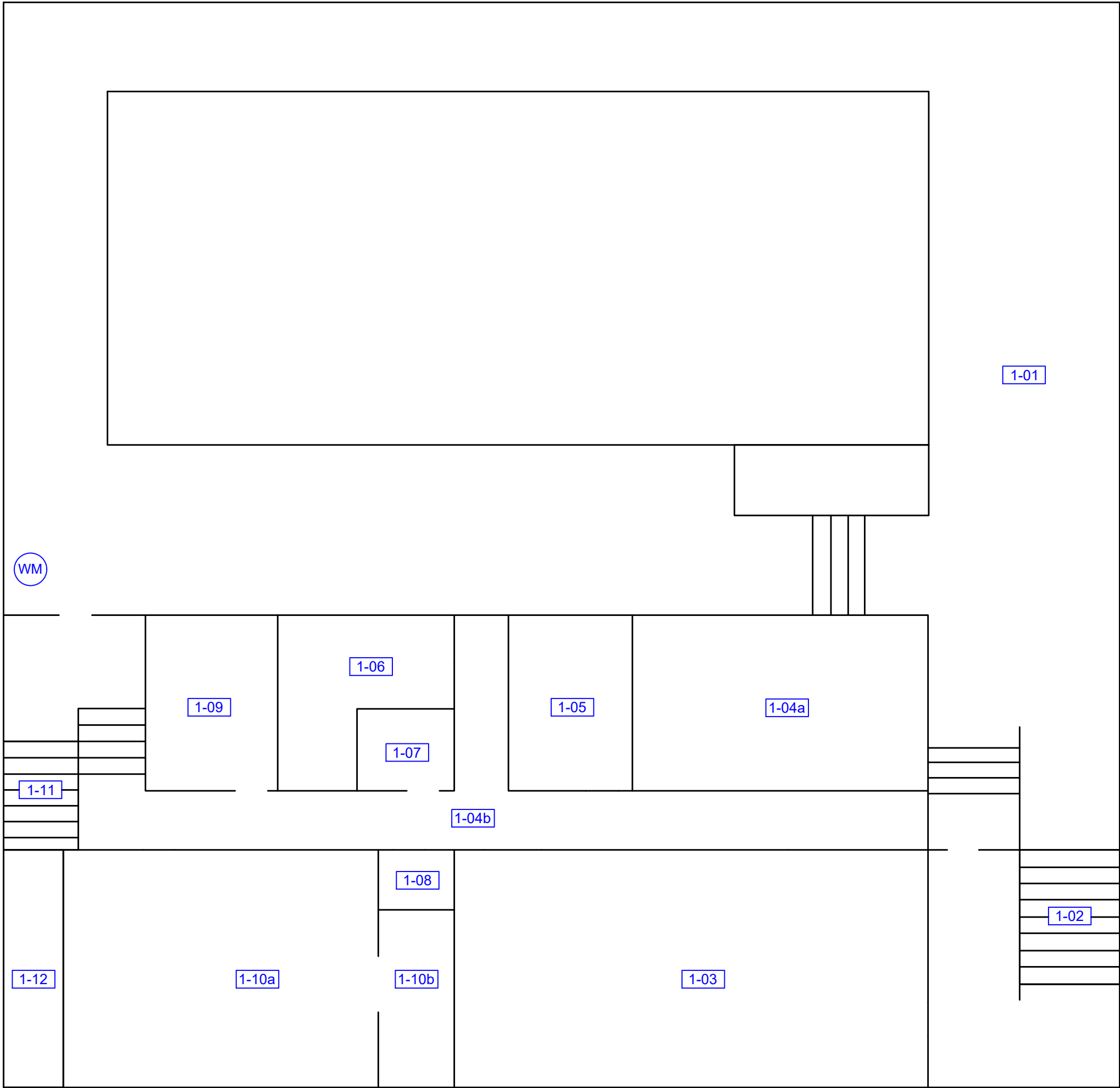

Legend



Assumed or Confirmed Asbestos
Containing Material

1-01

Location Number

NAR

No Access to Room

The drawing does not illustrate locations of drywall joint compound, plaster, texture finish, window caulking or roofing materials, for reasons discussed in Section 6 of the Standard Operating Procedure for Asbestos Reassessment Surveys. Please refer to the Asbestos Reassessment Survey Form in Appendix I for information regarding the locations and asbestos-content of these materials.

Figure 1

LOCATION:
313 Pharmacy Avenue
Toronto, Ontario

BUILDING NAME:
West Scarborough Neighbourhood
Community Centre

Lower Level Floor Plan
Locations of Designated Substances and
Hazardous Materials

CLIENT: City of Toronto



PROJECT NUMBER: 25715-B077 DATE: November 2020 DRW BY: PP

CAD FILE: Fig1-3 P25715-B077 ACM 313 Pharmacy Ave. SCALE: Not to Scale CHK BY: BS

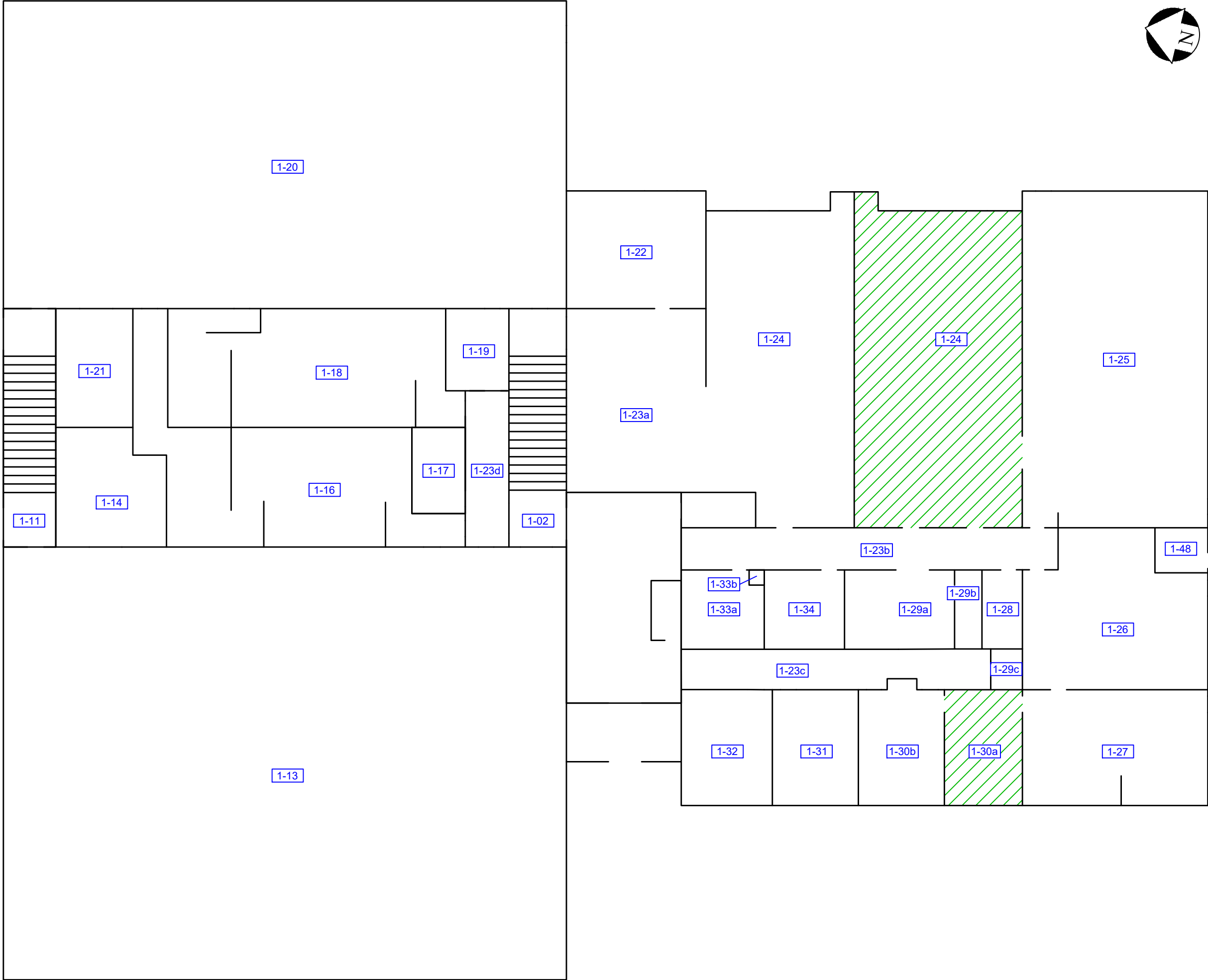

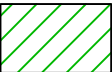
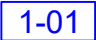

Legend

-  Assumed or Confirmed Asbestos Containing Material
-  Location Number
-  No Access to Room

The drawing does not illustrate locations of drywall joint compound, plaster, texture finish, window caulking or roofing materials, for reasons discussed in Section 6 of the Standard Operating Procedure for Asbestos Reassessment Surveys. Please refer to the Asbestos Reassessment Survey Form in Appendix I for information regarding the locations and asbestos-content of these materials.

Figure 2

LOCATION: 313 Pharmacy Avenue
Toronto, Ontario

BUILDING NAME: West Scarborough Neighbourhood
Community Centre



Main Floor Plan
Locations of Designated Substances and
Hazardous Materials

CLIENT: City of Toronto		
PROJECT NUMBER: 25715-B077	DATE: November 2020	DRW BY: PP
CAD FILE: Fig1-3 P25715-B077 ACM 313 Pharmacy Ave.	SCALE: Not to Scale	CHK BY: BS

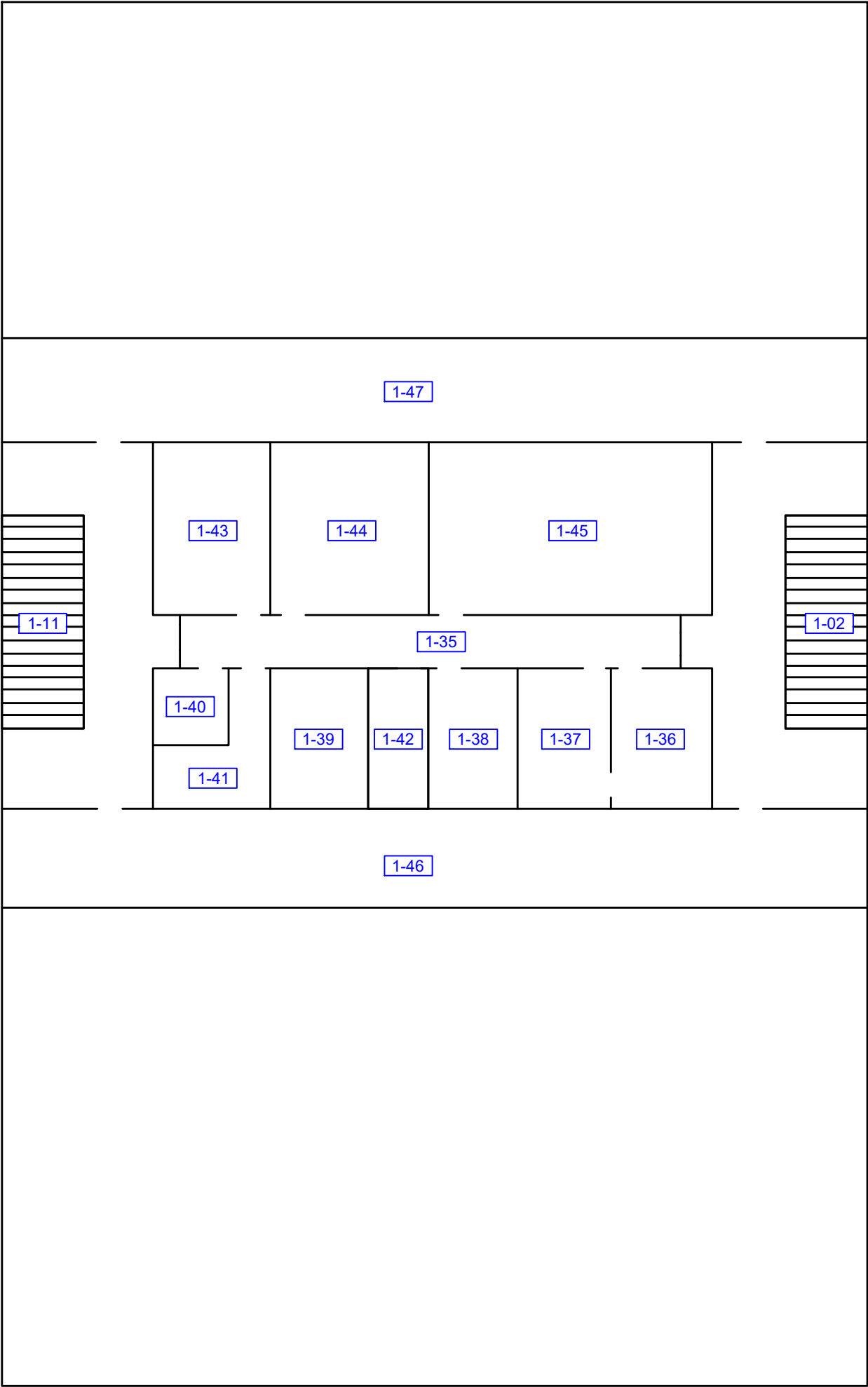

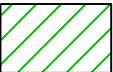
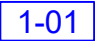

Legend

-  Assumed or Confirmed Asbestos Containing Material
-  Location Number
-  No Access to Room

The drawing does not illustrate locations of drywall joint compound, plaster, texture finish, window caulking or roofing materials, for reasons discussed in Section 6 of the Standard Operating Procedure for Asbestos Reassessment Surveys. Please refer to the Asbestos Reassessment Survey Form in Appendix I for information regarding the locations and asbestos-content of these materials.

Figure 3

LOCATION:
313 Pharmacy Avenue
Toronto, Ontario

BUILDING NAME:
West Scarborough Neighbourhood
Community Centre

Upper Level Floor Plan
Locations of Designated Substances and
Hazardous Materials

CLIENT: City of Toronto

PROJECT NUMBER: 25715-B077 DATE: November 2020 DRW BY: PP

CAD FILE: Fig1-3 P25715-B077 ACM 313 Pharmacy Ave. SCALE: Not to Scale CHK BY: BS

